

141

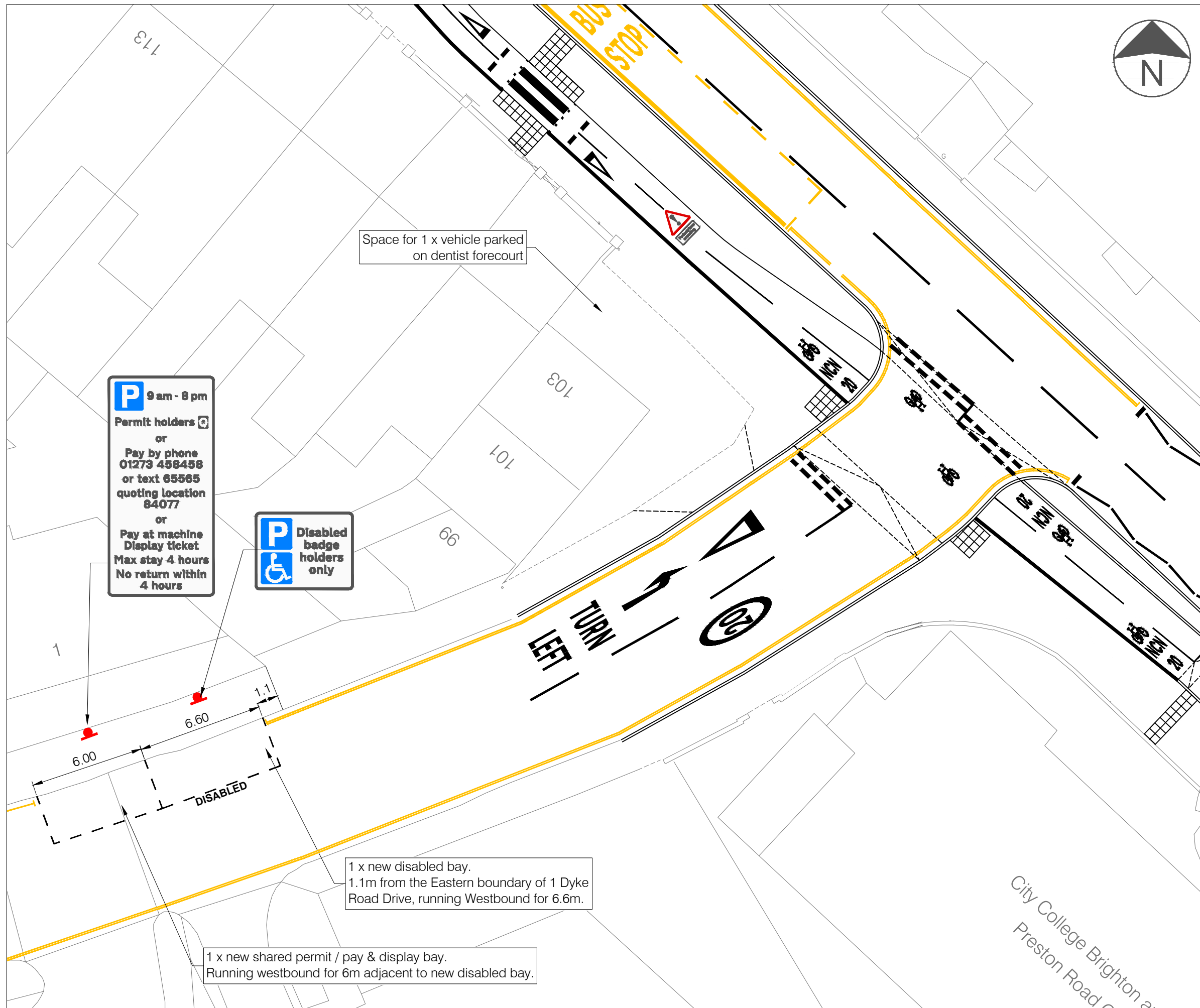

Space for 1 x vehicle parked on dentist forecourt

**P** 9 am - 8 pm  
 Permit holders   
 or  
 Pay by phone  
 01273 458458  
 or text 65565  
 quoting location  
 84077  
 or  
 Pay at machine  
 Display ticket  
 Max stay 4 hours  
 No return within  
 4 hours

**P** Disabled badge holders only

1 x new disabled bay.  
 1.1m from the Eastern boundary of 1 Dyke Road Drive, running Westbound for 6.6m.

1 x new shared permit / pay & display bay.  
 Running westbound for 6m adjacent to new disabled bay.

**LEGEND**

- Proposed Road Markings
- Proposed Double Yellow Lines
- Proposed Road Sign
- Existing Road Sign to be retained

Rev	Date	Description	Drn	Chk	App
D	07.06.23	UPDATED FOLLOWING BHCC COMMENTS	LG	RF	DP
C	24.04.23	UPDATED FOLLOWING BHCC COMMENTS	IC	RF	DP
B	27.03.23	UPDATE FOLLOWING BHCC COMMENTS	IC	RF	DP
A	24.03.23	FIRST ISSUE	IC	RF	DP

This drawing has been specifically prepared to meet the requirements of the named client and may contain design and innovative features which differ from conventional design standards.

**PROJECT CENTRE**

[www.marstonholdings.co.uk/projectcentre](http://www.marstonholdings.co.uk/projectcentre)

Client			
Project		A23 PEDESTRIAN / CYCLE IMPORVEMENTS	
Drawing Title		TRO PLAN DYKE ROAD DRIVE	
Drawing Status		<b>DRAFT FOR DISCUSSION</b>	
Drawn	Designed	Date	Scale
IC	RF	MAR 23	1:200
Drawing No.			Rev
1000008737-TRO-04			D

